

**Signal lamps with integrated filament/neon lamp, 14 mm**



**Technical data**

**General information**

Form of lens see order block  
 Colour of lens see order block  
 Diameter of collar see order block

**Dimensions**

Length of collar see order block  
 Width of collar see order block  
 Overall height 4 mm  
 Mounting depth see order block  
 Mounting hole 14 mm

**Mechanical design**

Mounting pressing into hole  
 Terminals see order block  
 Lamp socket no  
 Lamp see order block

**Electrical characteristics**

Voltage limit max. see order block  
 Power limit max. 1.2 W

**Other specifications**

Operating life see order block  
 Degree of protection from front side IP40  
 Weight 5 g  
 Approvals at 1.5 mA (T 85°C) VDE, SEV, FEMKO, DEMKO

3

Integr.  
Lamp

**Signal lamps with integrated filament lamp, 14 mm, round lens, 28 V**

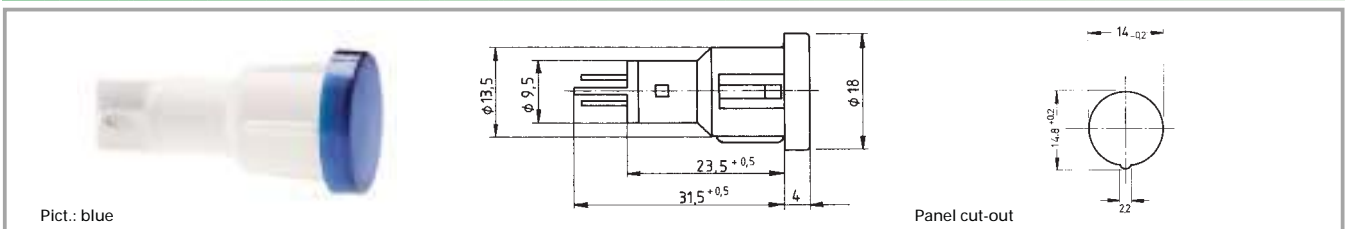

Voltage limit max.	Power limit max.	Lamp	Terminals	Operating life	Colour of lens	Order no.
28 V	1.2 W	filament lamp	quick connector 2.8 x 0.8 tin-plated	15000 h	transparent colourless	1.69.523.003/1002
28 V	1.2 W	filament lamp	quick connector 2.8 x 0.8 tin-plated	15000 h	transparent red	1.69.523.003/1301
28 V	1.2 W	filament lamp	quick connector 2.8 x 0.8 tin-plated	15000 h	transparent yellow	1.69.523.003/1402
28 V	1.2 W	filament lamp	quick connector 2.8 x 0.8 tin-plated	15000 h	transparent green	1.69.523.003/1502
28 V	1.2 W	filament lamp	quick connector 2.8 x 0.8 tin-plated	15000 h	transparent blue	1.69.523.003/1601

Technical data see page 3 - 32

## Signal lamps with integrated neon lamp, 14 mm, round lens, 230 V

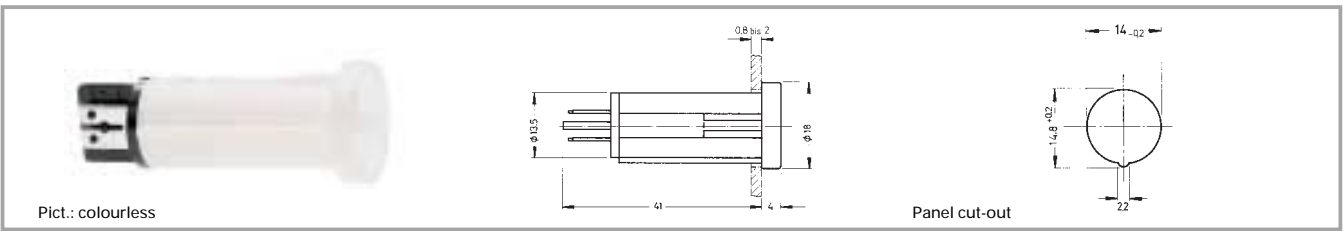

Voltage limit max.	Power limit max.	Lamp	Terminals	Operating life	Colour of lens	Order no.
230 V	1.2 W	neon lamp	quick connector 6.3 x 0.8 tin-plated		transparent colourless	1.02.614.502/1002
230 V	1.2 W	neon lamp	quick connector 6.3 x 0.8 tin-plated		transparent red	1.02.614.502/1301
230 V	1.2 W	neon lamp	quick connector 6.3 x 0.8 tin-plated		transparent yellow	1.02.614.502/1402
230 V	1.2 W	neon lamp	quick connector 2.8 x 0.8 tin-plated		transparent green	1.02.614.503/1502

Technical data see page 3 - 32

3

Integr.  
Lamp