



## General Data

### LUMOTAST 25 - Pushbutton range

- Illuminable pushbuttons and signal lamps.
- Mounting hole diameter: 16.2 mm
- 35 V/100 mA max.
- Water-jet proof IP65
- Low profile
- Lamp socket Bi-Pin T 1 for LEDs and filament lamps
- Keyed socket connector and flat ribbon cable or PCB plug-in socket
- Ring nut or click fixing method.

## Content

<b>LUMOTAST 25 - Illuminated pushbutton</b>	<b>1 - 22</b>
LUMOTAST 25 - Illuminated pushbutton with flush lens, „Click“ quick-assembly feature	1 - 24
LUMOTAST 25 - Illuminated pushbutton with flush lens, ring nut fixing	1 - 24
LUMOTAST 25 - Illuminated pushbutton with protruding lens, „Click“ quick-assembly feature	1 - 25
LUMOTAST 25 - Illuminated pushbutton with protruding lens, ring nut fixing	1 - 25
<b>LUMOTAST 25 - Selector switch</b>	<b>1 - 26</b>
LUMOTAST 25 - Selector switch, ring nut fixing	1 - 27
<b>LUMOTAST 25 - Keylock switch</b>	<b>1 - 28</b>
LUMOTAST 25 - Keylock switch	1 - 29
<b>LUMOTAST 25 - Emergency stop pushbutton</b>	<b>1 - 30</b>
LUMOTAST 25 - Emergency stop pushbutton, ring nut fixing	1 - 31
<b>LUMOTAST 25 - Signal lamp</b>	<b>1 - 32</b>
LUMOTAST 25 - Signal lamp, 24 V, „Click“ quick-assembly feature	1 - 33
LUMOTAST 25 - Signal lamp, 24 V, ring nut fixing	1 - 34

# Series LUMOTAST 25

16.2 mm mounting hole diameter

1

## Mounting of Click-Version

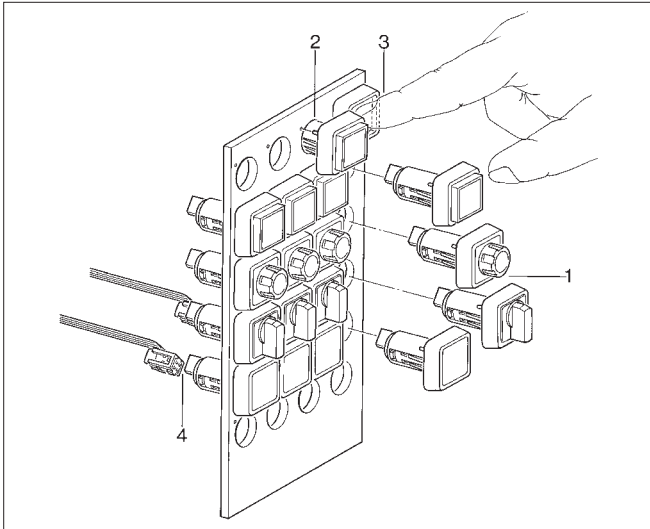

1. As delivered
2. Insert pushbutton in hole
3. Actuate once
4. Insert connector with flat-ribbon cable

## Disassembly Click-Version from Front Side

Click-Version from front (only for pushbuttons and signal lamps with special tool for dismounting)

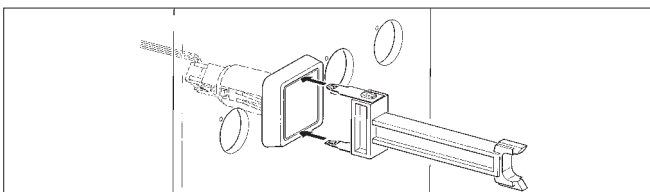

1. Grip body/lens

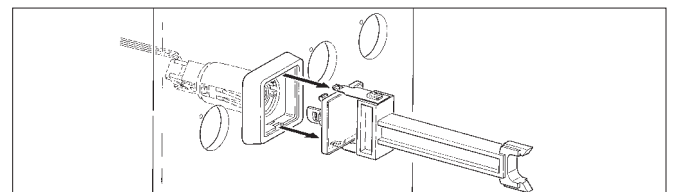

2. Pull out body/lens

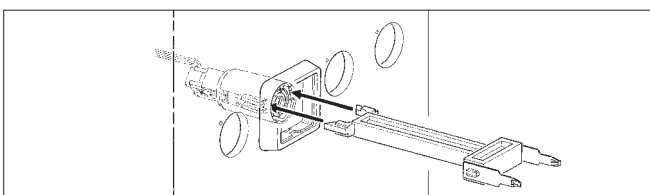

3. Release click lever

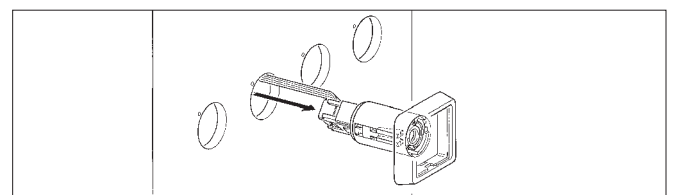

4. Pull out pushbutton/signal lamp with cable

**Dimensional drawing**

With quick connector and flat-ribbon cable

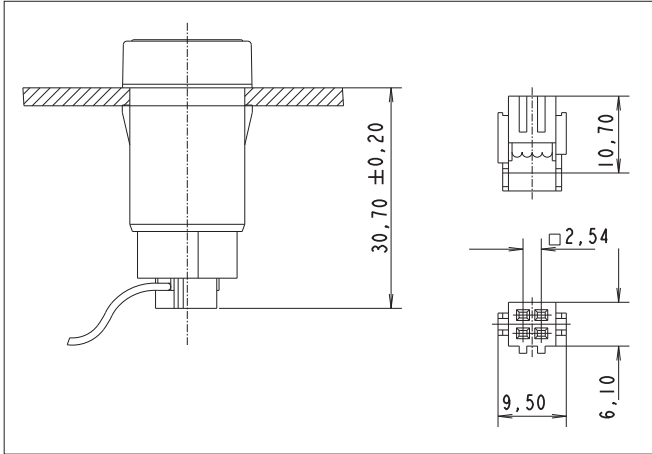

Connection diagram (PCB top view)

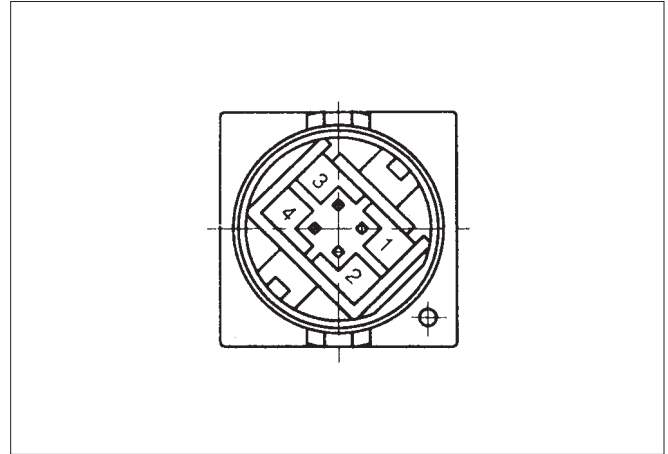

1 + 4 = pushbutton connection 2 + 3 = lamp connection

With plug-in socket

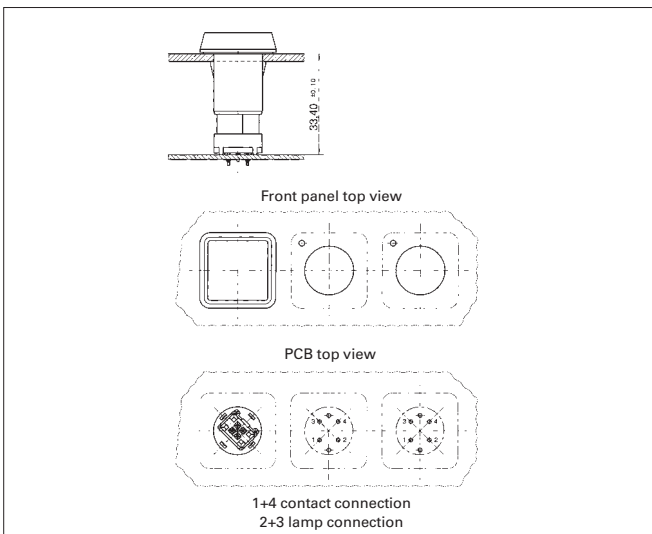

Plug-in socket for PCB

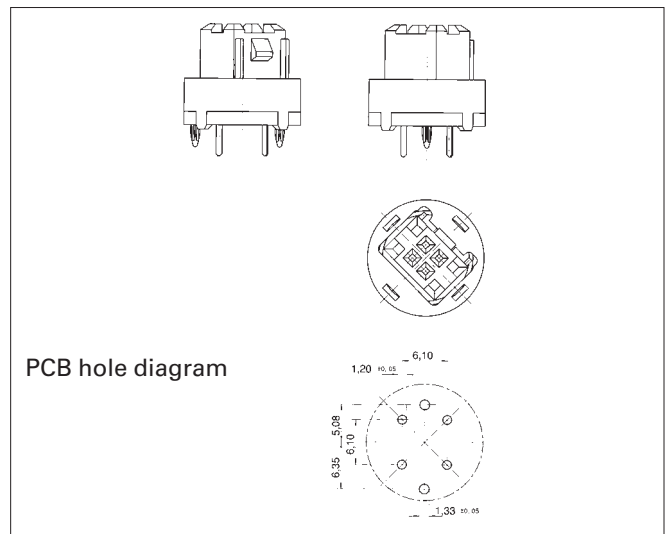

**LUMOTAST 25 - Illuminated pushbutton**



**Technical Data**

**General information**

Form of lens	see order block
Colour of lens	see order block
Form of collar	square

**Dimensions**

Length of collar	25 mm
Width of collar	25 mm
Overall height	7.1 mm
Mounting depth with connector	30.7 mm
Mounting depth with plug-in socket	33.4 mm
Mounting hole	16.2 mm

**Mechanical design**

Mounting	see order block
Terminals	pin connector
Contact system	4-pol./ plug-in socket
Contact function	snap-action contact
Contact arrangement	momentary
Contact materials	1 NO
Illumination	Au
Lamp socket	yes
	Bi-PinT1 / T1¼

**Mechanical characteristics**

Operating force max.	6 N
Operating travel	3 mm
Switching travel	2 mm
Robustness min.	100 N

**Electrical characteristics**

Rated voltage AC/DC max.	35 V
Rated voltage AC/DC min.	0.02 V
Rated current AC/DC max.	100 mA
Rated current AC/DC min.	0.01 mA
Contact resistance max.	100 mΩ
Bouncing time max.	5 ms















**Other specifications**

Operating life (operations)	1,000,000
Degree of protection from front side	IP65
Ambient temp. operating max. without lamp /LED	-25 °C
Ambient temp. operating max. without lamp /LED	+70 °C
Ambient temp. operating min. with lamp /LED	-25 °C
Ambient temp. operating max. with lamp /LED	+55 °C
Storage temperature min.	-40 °C
Storage temperature max.	+80 °C
Environmental resistance	acc. to IEC 60068-2 -14, -30, -33 and -78
Weight	7 g

**Typical accessories LUMOTAST 25 - Illuminated pushbutton**

Description	Photo	Order no.	Additional accessories see page
Filament lamp, Bi-PinT 1¼ base, 12 V		<b>1.90.180.474/0000</b>	5 - 5
Filament lamp, Bi-PinT 1¼ base, 28 V		<b>1.90.180.475/0000</b>	5 - 5
LED Bi-PinT 1 superbright, red, 24 V		<b>1.90.690.351/0000</b>	5 - 15
LED Bi-PinT 1 superbright, green, 24 V		<b>1.90.690.352/0000</b>	5 - 15

**Typical accessories LUMOTAST 25 - Illuminated pushbutton**

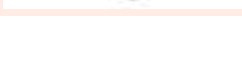
Description	Photo	Order no.	Additional accessories see page
LED Bi-PinT 1 superbright, yellow, 24V		<b>1.90.690.353/0000</b>	5 - 15
LED Bi-PinT 1 superbright, blue, 24V		<b>1.90.690.354/0000</b>	5 - 15
LED Bi-PinT 1 superbright, white, 24V		<b>1.90.690.355/0000</b>	5 - 15
LED Bi-PinT 1, red, 3V		<b>1.90.691.026/0000</b>	5 - 15
LED Bi-PinT 1, green, 3V		<b>1.90.691.027/0000</b>	5 - 15
LED Bi-PinT 1, yellow, 3V		<b>1.90.691.028/0000</b>	5 - 15
Plug-in socket for PCB		<b>5.00.645.036/0000</b>	5 - 23
Cable (flat ribbon cable 10 cm with socket connector and male quick connector, AMP 4-pin)		<b>5.03.771.306/0000</b>	5 - 22
Disassembly tool for LUMOTAST 25, RAFIX 16		<b>5.05.800.042/0000</b>	2 - 94
Blanking cap complete with sealing disc and ring nut, square		<b>5.05.800.049/0100</b>	2 - 100, 5 - 26
Label holder, flush, for square collar		<b>5.07.620.004/0000</b>	2 - 96
Flat ribbon cable, 4-wire, 1 m long		5.37.700.124/0000	5 - 23
Fixing spanner M 15, M 16		5.58.002.019/0105	5 - 21
Legend insert, blank, use only for transparent lenses		<b>5.70.635.000/2000</b>	
Legend label 23 x 16 for label holder, without legend		<b>5.73.111.000/0000</b>	
Socket connector, 4-pin		<b>5.92.025.368/0000</b>	5 - 22

1

LUMO  
25

1

**LUMOTAST 25 - Illuminated pushbutton with flush lens, „Click“ quick-assembly feature**

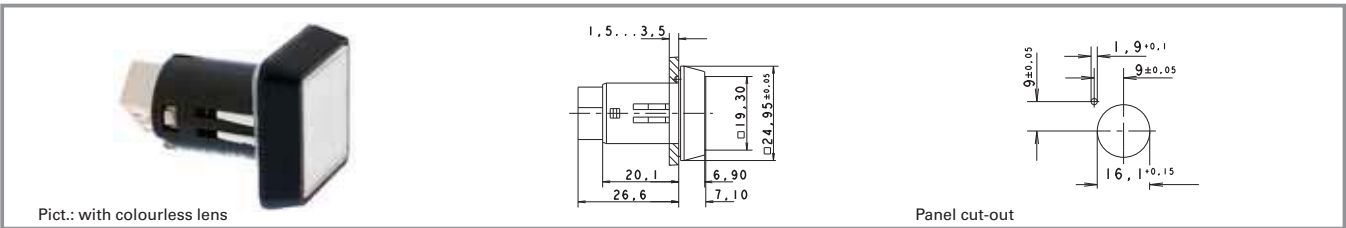

Contact function	Contact arrangement	Order no. without lens	Note
momentary	1 NO	<b>1.15.150.506/0000</b>	Please include the desired lens in your order.

Technical data see page 1 - 22

**Lenses:**

- Lens, square, transparent colourless: 5.49.077.011/1002
- Lens, square, transparent red: 5.49.077.011/1306
- Lens, square, transparent yellow: 5.49.077.011/1403
- Lens, square, transparent green: 5.49.077.011/1505
- Lens, square, transparent blue: 5.49.077.011/1607

Note when using LEDs: A notch on the lamp socket identifies the cathode side.

LUMO  
25

**LUMOTAST 25 - Illuminated pushbutton with flush lens, ring nut fixing**

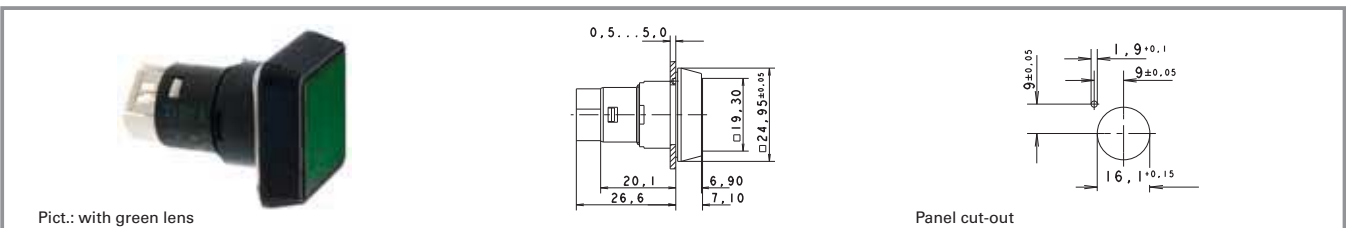

Contact function	Contact arrangement	Order no. without lens	Note
momentary	1 NO	<b>1.15.150.556/0000</b>	Please include the desired lens in your order.

Technical data see page 1 - 22

**Lenses:**

- Lens, square, transparent colourless: 5.49.077.011/1002
- Lens, square, transparent red: 5.49.077.011/1306
- Lens, square, transparent yellow: 5.49.077.011/1403
- Lens, square, transparent green: 5.49.077.011/1505
- Lens, square, transparent blue: 5.49.077.011/1607

Note when using LEDs: A notch on the lamp socket identifies the cathode side.

**LUMOTAST 25 - Illuminated pushbutton with protruding lens, „Click“ quick-assembly feature**

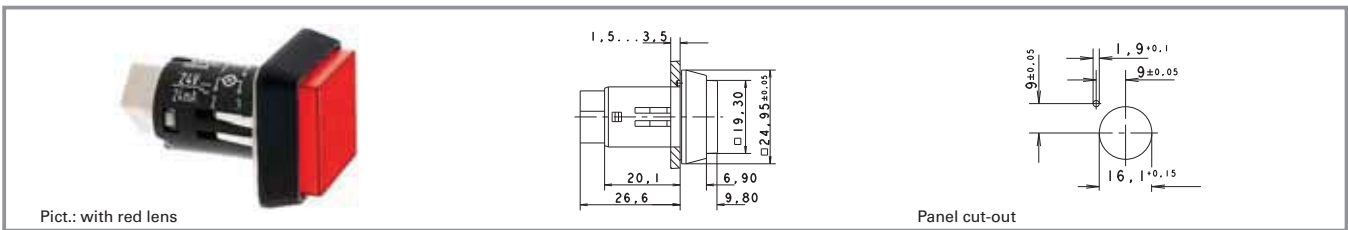

Contact function	Contact arrangement	Order no. without lens	Note
momentary	1 NO	<b>1.15.150.606/0000</b>	Please include the desired lens in your order.

Technical data see page 1 - 22

**Lenses:**

- Lens, square, transparent colourless: 5.49.077.012/1002
- Lens, square, transparent red: 5.49.077.012/1306
- Lens, square, transparent yellow: 5.49.077.012/1403
- Lens, square, transparent green: 5.49.077.012/1505
- Lens, square, transparent blue: 5.49.077.012/1607

Note when using LEDs: A notch on the lamp socket identifies the cathode side.

1

LUMO  
25

**LUMOTAST 25 - Illuminated pushbutton with protruding lens, ring nut fixing**

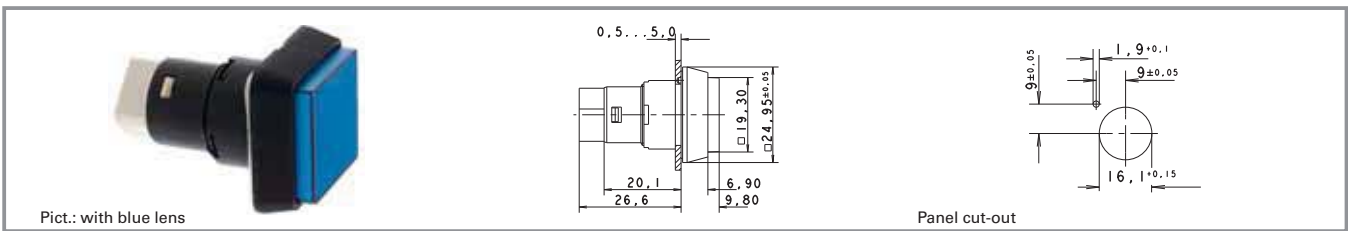

Contact function	Contact arrangement	Order no. without lens	Note
momentary	1 NO	<b>1.15.150.656/0000</b>	Please include the desired lens in your order.

Technical data see page 1 - 22

**Lenses:**

- Lens, square, transparent colourless: 5.49.077.012/1002
- Lens, square, transparent red: 5.49.077.012/1306
- Lens, square, transparent yellow: 5.49.077.012/1403
- Lens, square, transparent green: 5.49.077.012/1505
- Lens, square, transparent blue: 5.49.077.012/1607

Note when using LEDs: A notch on the lamp socket identifies the cathode side.

**LUMOTAST 25 - Selector switch**



Panel cut-out

**Technical Data**

LUMO  
25

**General information**

Actuator	handle
Colour of handle	black opaque
Form of collar	square

**Dimensions**

Length of collar	25 mm
Width of collar	25 mm
Overall height	17 mm
Mounting depth with connector	30.7 mm
Mounting depth with plug-in socket	33.4 mm
Mounting hole	16.2 mm

**Mechanical design**

Mounting	see order block
Terminals	pin connector
	4-pol./ plug-in socket
Contact system	snap-action contact
Contact function	see order block
Contact arrangement	1 NO
Contact materials	Au
Illumination	no

**Mechanical characteristics**

Operating force min.	0.03 Nm
Rotating angle	see order block
Robustness max.	1.5 N

**Electrical characteristics**

Rated voltage AC/DC max.	35 V
Rated voltage AC/DC min.	0.02 V
Rated current AC/DC max.	100 mA
Rated current AC/DC min.	0.01 mA
Contact resistance max.	100 mΩ
Bouncing time max.	5 ms

**Other specifications**

Operating life (operations)	500,000
Degree of protection from front side	IP65
Operation temperature min.	-25 °C
Ambient temp. operating max.	+70 °C
Storage temperature min.	-40 °C
Storage temperature max.	+80 °C
Environmental resistance	acc. to IEC 60068-2 -14, -30, -33 and -78
Weight	8 g

**Typical accessories LUMOTAST 25 - Selector switch**

Description	Photo	Order no.	Additional accessories see page
Plug-in socket for PCB		<b>5.00.645.036/0000</b>	5 - 23
Cable (flat ribbon cable 10 cm with socket connector and male quick connector, AMP 4-pin)		<b>5.03.771.306/0000</b>	5 - 22
Blanking cap complete with sealing disc and ring nut, square		<b>5.05.800.049/0100</b>	2 - 100, 5 - 26
Label holder, flush, for square collar		<b>5.07.620.004/0000</b>	2 - 96
Flat ribbon cable, 4-wire, 1 m long		5.37.700.124/0000	5 - 23



**Typical accessories LUMOTAST 25 - Selector switch**

Description	Photo	Order no.	Additional accessories see page
Fixing spanner M 15, M 16		5.58.002.019/0105	5 - 21
Socket connector, 4-pin		5.92.025.368/0000	5 - 22

**LUMOTAST 25 - Selector switch, ring nut fixing**

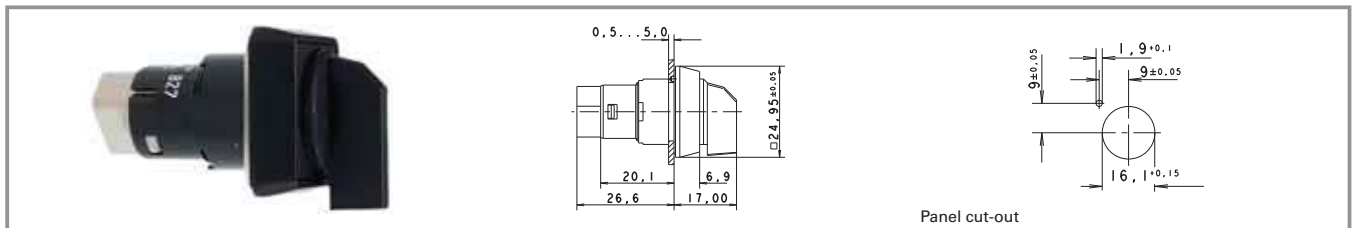

Contact arrangement	Contact function	Rotating angle	Actuator	Order no.
1 NO	latching	right, 1 x 90°	handle	1.15.153.106/0100

Technical data see page 1 - 26

## LUMOTAST 25 - Keylock switch

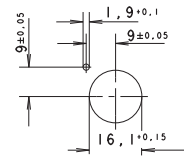

Panel cut-out

### Technical Data

#### General information

Colour of lens	black opaque
Form of collar	square

#### Dimensions

Length of collar	25 mm
Width of collar	25 mm
Overall height	32.3 mm
Mounting depth with connector	30.7 mm
Mounting depth with plug-in socket	33.4 mm
Mounting hole	16.2 mm

#### Mechanical design

Mounting	ring nut
Terminals	pin connector
	4-pol./ plug-in socket
Contact system	snap-action contact
Contact function	latching
Contact arrangement	1 NO
Contact materials	Au
Illumination	no
Lamp socket	no
Lock	cylinder lock
Wafers	8 pins
Lock type	5201
Number of locking positions	10,000
Main key	yes
Symmetric key	yes
Key removal position	see order block

#### Mechanical characteristics

Operating force max.	1.5 N
Rotating angle	90°

#### Electrical characteristics

Rated voltage AC/DC max.	35 V
Rated voltage AC/DC min.	0.02 V
Rated current AC/DC max.	100 mA
Rated current AC/DC min.	0.01 mA
Contact resistance max.	100 mΩ
Bouncing time max.	5 ms

#### Other specifications

Operating life (operations)	50,000
Degree of protection from front side	IP65
Operation temperature min.	-25 °C
Ambient temp. operating max.	+70 °C
Storage temperature min.	-40 °C
Storage temperature max.	+80 °C
Environmental resistance	acc. to IEC 60068-2 -14, -30, -33 and -78
Weight	20 g

### Typical accessories LUMOTAST 25 - Keylock switch

Description	Photo	Order no.	Additional accessories see page
Plug-in socket for PCB		<b>5.00.645.036/0000</b>	5 - 23
Cable (flat ribbon cable 10 cm with socket connector and male quick connector, AMP 4-pin)		<b>5.03.771.306/0000</b>	5 - 22
Blanking cap complete with sealing disc and ring nut, square		<b>5.05.800.049/0100</b>	2 - 100, 5 - 26

**Typical accessories LUMOTAST 25 - Keylock switch**

Description	Photo	Order no.	Additional accessories see page
Label holder, flush, for square collar		<b>5.07.620.004/0000</b>	2 - 96
Flat ribbon cable, 4-wire, 1 m long		5.37.700.124/0000	5 - 23
Fixing spanner M 15, M 16		5.58.002.019/0105	5 - 21
Spare key set (2 keys)		5.58.015.201/0000	
Legend label 23 x 16 for label holder, without legend		<b>5.73.111.000/0000</b>	
Socket connector, 4-pin		<b>5.92.025.368/0000</b>	5 - 22

1

LUMO  
25

**LUMOTAST 25 - Keylock switch**

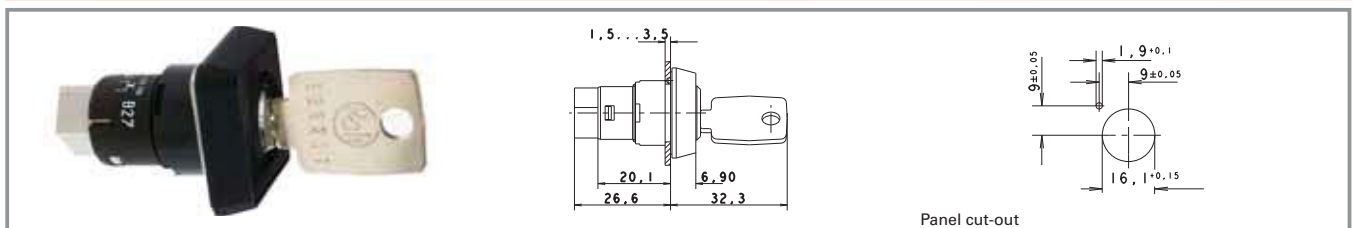

Contact arrangement	Contact function	Rotating angle	Key removal position	Colour of lens	Order no.
1 NO	latching	90°	0	black opaque	<b>1.15.156.001/0000</b>
1 NO	latching	90°	0 + 1	black opaque	<b>1.15.156.011/0000</b>

Technical data see page 1 - 28

Included: 2 keys.

**LUMOTAST 25 - Emergency stop pushbutton**



Pict.: yellow collar

black collar

Panel cut-out

**Technical Data**

LUMO  
25

**General information**

Colour of lens	opaque red
Form of collar	square
Colour of collar	see order block

**Dimensions**

Length of collar	25 mm
Width of collar	25 mm
Overall height	18.5 mm
Mounting depth with connector	30.7 mm
Mounting depth with plug-in socket	33.4 mm
Mounting hole	16.2 mm

**Mechanical design**

Mounting	ring nut
Terminals	pin connector
Contact system	4-pol./ plug-in socket
Contact function	snap-action contact
Contact arrangement	latching
	2 NC (forcibly actuated)
Contact materials	Au
Illumination	no
Reset	by pulling

**Mechanical characteristics**

Operating force max.	10 N
Operating travel	2.6 mm
Switching travel	2 mm
Robustness min.	100 N

**Electrical characteristics**

Rated voltage AC/DC max.	25 V
Rated voltage AC/DC min.	0.02 V
Rated current AC/DC max.	100 mA (1A short-circuit current)
Rated current AC/DC min.	0.01 mA
Contact resistance max.	100 mΩ
Bouncing time max.	10 ms

**Other specifications**

Operating life (operations)	15,000
Degree of protection from front side	IP65
Operation temperature min.	-25 °C
Ambient temp. operating max.	+70 °C
Storage temperature min.	-40 °C
Storage temperature max.	+80 °C
Environmental resistance	acc. to IEC 60068-2
	-14, -30, -33 and -78
Weight	9 g

**Approvals**



IEC 60947-5-x,  
60904, 60073



UL 508

**Typical accessories LUMOTAST 25 - Emergency stop pushbutton**

Description	Photo	Order no.	Additional accessories see page
Plug-in socket for PCB		<b>5.00.645.036/0000</b>	5 - 23
Cable (flat ribbon cable 10 cm with socket connector and male quick connector, AMP 4-pin)		<b>5.03.771.306/0000</b>	5 - 22
Blanking cap complete with sealing disc and ring nut, square		<b>5.05.800.049/0100</b>	2 - 100, 5 - 26
Label holder, flush, for square collar		<b>5.07.620.004/0000</b>	2 - 96
Flat ribbon cable, 4-wire, 1 m long		5.37.700.124/0000	5 - 23
Fixing spanner M 15, M 16		5.58.002.019/0105	5 - 21
Legend label 23 x 16 for label holder, without legend		<b>5.73.111.000/0000</b>	
Adhesive label yellow, round 16.1 / 60 mm, without legend		5.76.204.425/0400	
Adhesive label yellow, round 16.1 / 60 mm, with legend „Not-Aus“		5.76.204.426/0400	
Adhesive label yellow, round 16.1 / 60 mm, with legend „ARRET-D'URGENCE“		5.76.204.427/0400	
Adhesive label yellow, round 16.1 / 60 mm, with legend „EMERGENCY-STOP“		5.76.204.428/0400	
Adhesive label yellow, round 16.1 / 60 mm, with legend „ARRESTO-D'EMERGENZA“		5.76.204.429/0400	
Socket connector, 4-pin		<b>5.92.025.368/0000</b>	5 - 22

1

LUMO  
25

**LUMOTAST 25 - Emergency stop pushbutton, ring nut fixing**

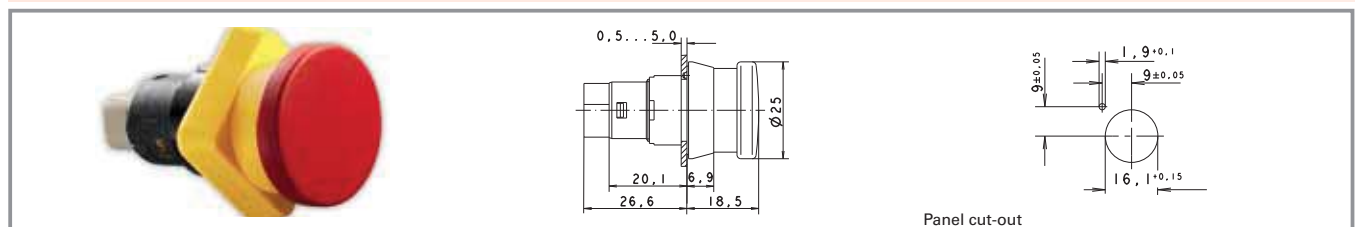

Contact function	Contact arrangement	Colour of collar	Order no. complete	Order no. single parts	
				Housing	Lens
latching	2 NC (forcibly actuated)	black	<b>1.15.154.006/0301</b>	-	-
latching	2 NC (forcibly actuated)	yellow	<b>1.15.154.016/0301</b>	-	-

Technical data see page 1 - 30

## LUMOTAST 25 - Signal lamp



Pict.: with red lens



with blue lens

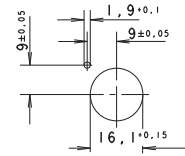

Panel cut-out

### Technical Data

#### General information

Form of lens	square
Colour of lens	see order block

#### Dimensions

Length of collar	25 mm
Width of collar	25 mm
Overall height	9.8 mm
Mounting depth with connector	30.7 mm
Mounting depth with plug-in socket	33.4 mm
Mounting hole	16.2 mm

#### Mechanical design

Mounting	see order block
Terminals	pin connector 4-pol./ plug-in socket
Lamp socket	see order block
Lamp	filament lamp / LED

#### Electrical characteristics

Voltage limit max.	24 V
Power limit max.	0.7 W

#### Other specifications

Degree of protection from front side	IP65
Weight	7 g
Operation temperature min.	-25 °C
Ambient temp. operating max.	+70 °C
Storage temperature min.	-40 °C
Storage temperature max.	+80 °C

### Typical accessories LUMOTAST 25 - Signal lamp

Description	Photo	Order no.	Additional accessories see page
Filament lamp, Bi-PinT 1¼ base, 12 V		<b>1.90.180.474/0000</b>	5 - 5
Filament lamp, Bi-PinT 1¼ base, 28 V		<b>1.90.180.475/0000</b>	5 - 5
LED Bi-PinT 1 superbright, red, 24 V		<b>1.90.690.351/0000</b>	5 - 15
LED Bi-PinT 1 superbright, green, 24 V		<b>1.90.690.352/0000</b>	5 - 15
LED Bi-PinT 1 superbright, yellow, 24 V		<b>1.90.690.353/0000</b>	5 - 15
LED Bi-PinT 1 superbright, blue, 24 V		<b>1.90.690.354/0000</b>	5 - 15
LED Bi-PinT 1 superbright, white, 24 V		<b>1.90.690.355/0000</b>	5 - 15
LED Bi-PinT 1, red, 3 V		<b>1.90.691.026/0000</b>	5 - 15

**Typical accessories LUMOTAST 25 - Signal lamp**

Description	Photo	Order no.	Additional accessories see page
LED Bi-PinT 1, green, 3V		<b>1.90.691.027/0000</b>	5 - 15
LED Bi-PinT 1, yellow, 3V		<b>1.90.691.028/0000</b>	5 - 15
Plug-in socket for PCB		<b>5.00.645.036/0000</b>	5 - 23
Cable (flat ribbon cable 10 cm with socket connector and male quick connector, AMP 4-pin)		<b>5.03.771.306/0000</b>	5 - 22
Disassembly tool for LUMOTAST 25, RAFIX 16		<b>5.05.800.042/0000</b>	2 - 94
Blanking cap complete with sealing disc and ring nut, square		<b>5.05.800.049/0100</b>	2 - 100, 5 - 26
Label holder, flush, for square collar		<b>5.07.620.004/0000</b>	2 - 96
Flat ribbon cable, 4-wire, 1 m long		5.37.700.124/0000	5 - 23
Fixing spanner M 15, M 16		5.58.002.019/0105	5 - 21
Legend insert, blank, use only for transparent lenses		<b>5.70.635.000/2000</b>	
Legend label 23 x 16 for label holder, without legend		<b>5.73.111.000/0000</b>	
Socket connector, 4-pin		<b>5.92.025.368/0000</b>	5 - 22

1

LUMO  
25

**LUMOTAST 25 - Signal lamp, 24V, „Click“ quick-assembly feature**

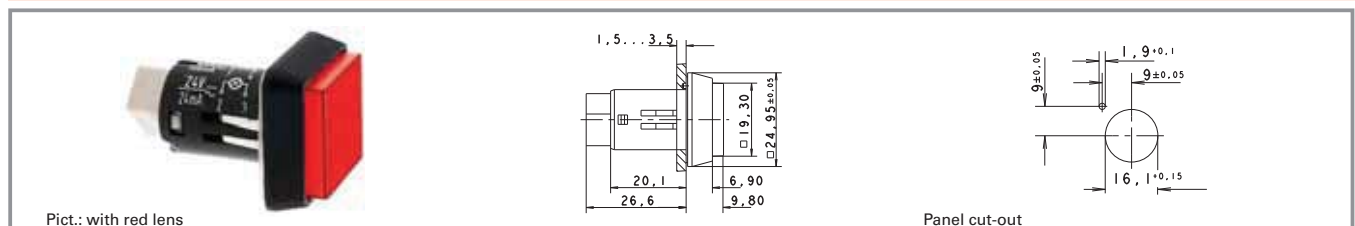

Voltage limit max.	Power limit max.	Lamp socket	Order no. without lens	Note
24 V	0.7 W	Bi-PinT 1/T 1¼	1.65.122.906/0000	Please include the desired lens in your order.

Technical data see page 1 - 32

**Lenses:**

- Lens, square, transparent colourless: 5.49.077.014/1002
- Lens, square, transparent red: 5.49.077.014/1306
- Lens, square, transparent yellow: 5.49.077.014/1403
- Lens, square, transparent green: 5.49.077.014/1505
- Lens, square, transparent blue: 5.49.077.014/1607

Do not press in lens in disassembled condition.  
Note when using a LED: A notch on the lamp identifies the cathode side.

Pushbuttons

**Stock items** are marked by **bold printed order numbers.**

1

**LUMOTAST 25 - Signal lamp, 24 V, ring nut fixing**

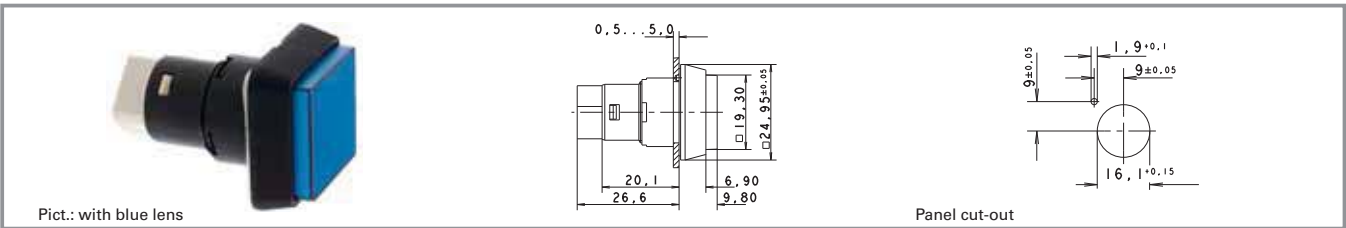

Voltage limit max.	Power limit max.	Lamp socket	Order no. without lens	Note
24 V	0.7 W	Bi-Pin T 1/T 1¼	1.65.122.956/0000	Please include the desired lens in your order.

Technical data see page 1 - 32

LUMO  
25

**Lenses:**

- Lens, square, transparent colourless: 5.49.077.014/1002
- Lens, square, transparent red: 5.49.077.014/1306
- Lens, square, transparent yellow: 5.49.077.014/1403
- Lens, square, transparent green: 5.49.077.014/1505
- Lens, square, transparent blue: 5.49.077.014/1607

Do not press in lens in disassembled condition.

Note when using LED: A notch on the lamp socket identifies the cathode side.